

PORTABLE BILLBOARD A SIGN

Assembly Instructions | R1.040116

ASSEMBLY HARDWARE

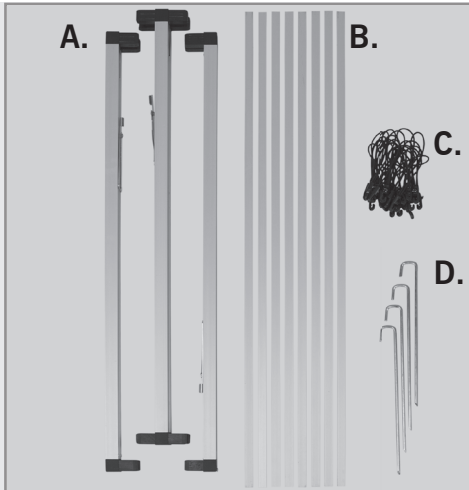

- A. Aluminum support pole sets w/ hinge
- B. Aluminum tubes
- C. Black elastic banner cords w/ hook
- D. Ground stakes

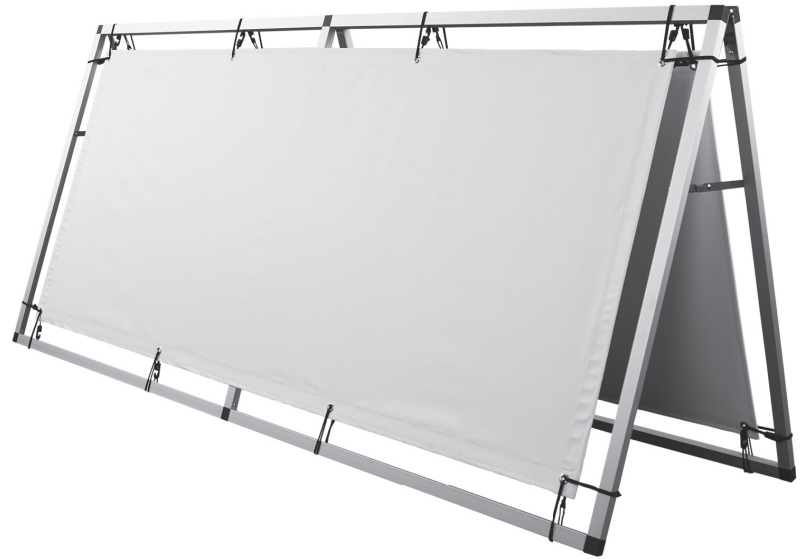

PRODUCT ASSEMBLY

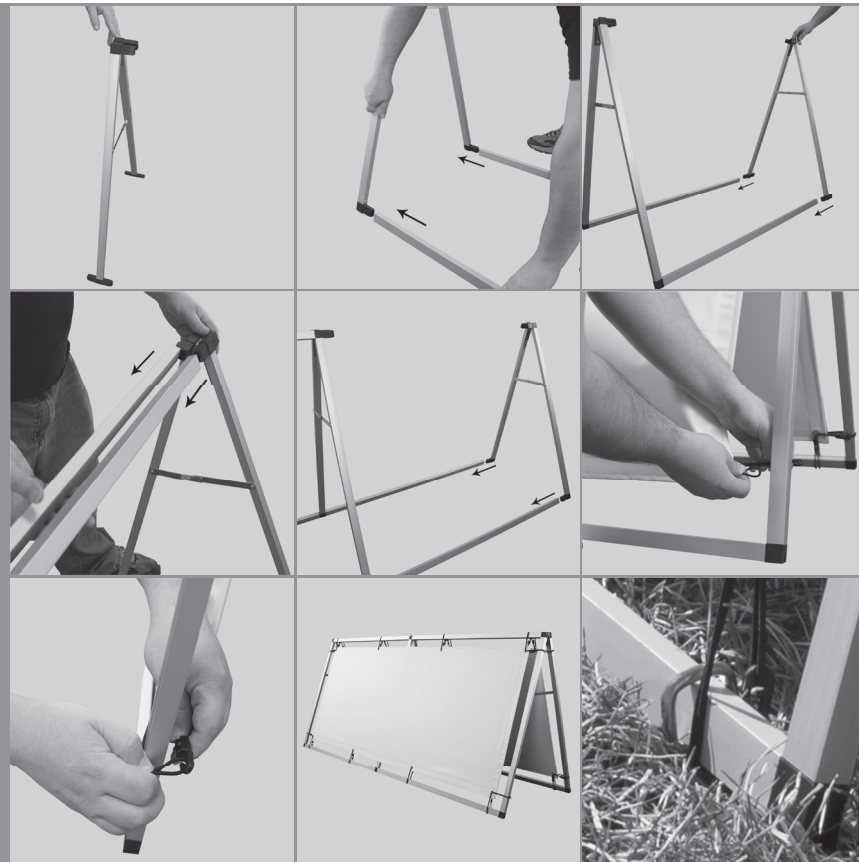

Frame Assembly

1. Extend one of the 2 end aluminum support pole sets with hinge. Connect 2 aluminum tubes to the bottom of the support pole by placing them on the end of the feet and pushing in.
2. Extend the center aluminum support pole set with hinge (has feet extending in both directions) and insert into the end of the aluminum tubes. Insert 2 aluminum tubes into the top brackets.

3. Connect the remaining end aluminum support pole set with hinge and aluminum tubes to the other side of the center aluminum support pole with hinge.

Print Attachment

4. Start attaching the print by attaching the top corners. Each corner requires 2 black elastic banner cords with hooks. To attach these, slide the unhooked end through the grommet, wrap around the frame and connect to the hook. One of these should wrap around the aluminum tube and the other should wrap around the support pole. Connect the remaining corners.
5. Attach the remainder of the print by sliding 1 black elastic banner cord with hook through each grommet and connecting it to the frame. Repeat if necessary for the other print.
6. Insert stakes if necessary by placing long side inside frame at each corner and pushing down.

ACCESSORY ASSEMBLY



8. Place a weight plate in the middle of each section. Slide a black elastic banner cord with hook through the opening on each side and attach it to the bottom aluminum tube. Repeat for the other side and the other plate.
9. Fill the weight bags with either water or sand and place them on top of the plates.



DISCLAIMER: Do not display this banner stand in wind gusts exceeding 20-25mph and/or thunderstorms. Fasten with ground stakes for security. User must read and observe assembly instructions. Allow a 5' radius from display for print clearance. If this is not done correctly, it may result in damage to the unit, injury or death, and all warranties will be void. All warranties will be void if this product is used with any banner or hardware not produced by us.

