

HALF MOON STAND

Assembly Instructions | R1.020718

ASSEMBLY HARDWARE

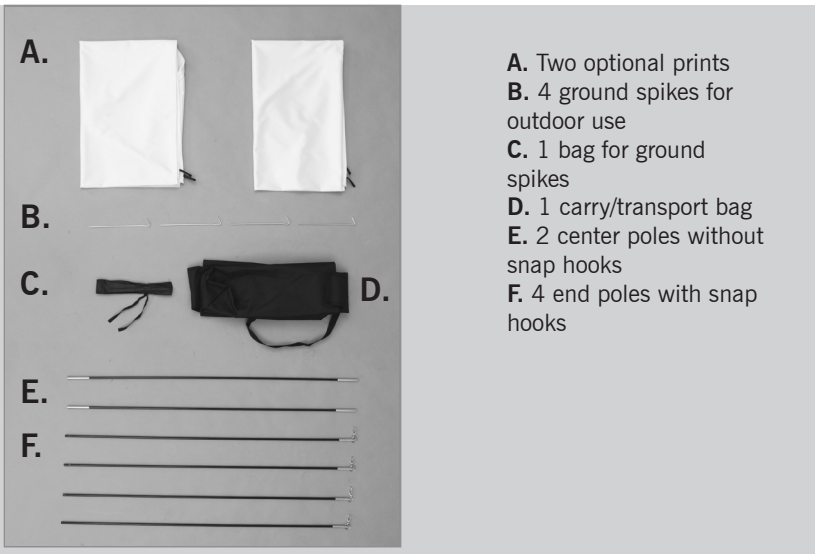

ASSEMBLY

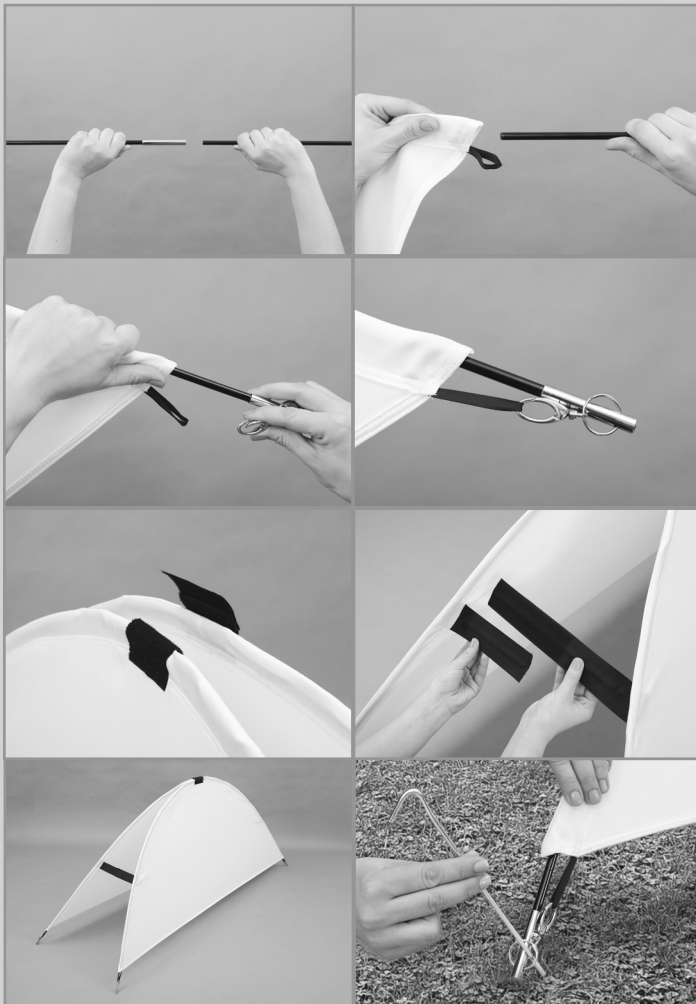

1. Start by removing the prints, hooks and poles from the carry bag. Place them on a clean, flat surface.
2. Connect one of the end poles with snap hooks to one of the center poles. Slide the connected poles through the sleeve on the upper edge of the print.
3. Connect another end pole to the poles from Step 2.
4. Repeat steps 2 and 3 on the other side of the banner.
5. Attach the black loops on each side of the print to the snap hooks on the end poles.
6. Place both prints on the long sides of the banner and connect them using the hook-and-loop bands that are located opposite each other on the top.
7. Close the side hook-and-loop straps.
8. **For outdoor use:** Slide the ground spikes into the metal ring at the end of each end pole and push them into the ground.