

## ASSEMBLY HARDWARE

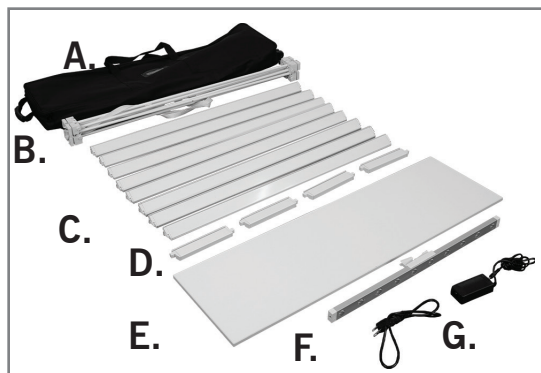

- A. CARRYING CASE
- B. FRAME
- C. CHANNEL BARS
- D. SIDE CHANNEL BARS
- E. COUNTER TOP
- F. LED LIGHT
- G. POWER CORD AND TRANSFORMER



## FRAME ASSEMBLY AND PRINT ATTACHMENT

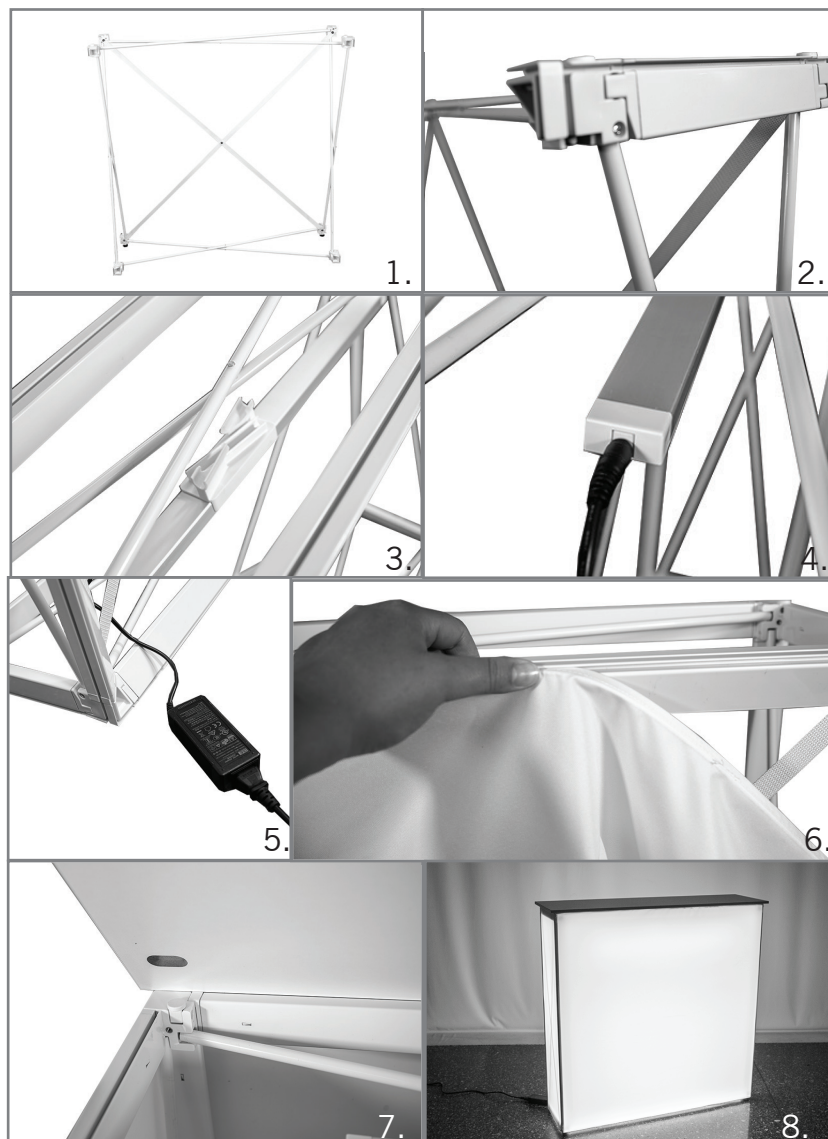

### ASSEMBLY

1. Place fully collapsed frame on the ground and expand it outwards.
2. Place the short side channels at the top and bottom of the frame. (The short side of the frame.) Once those are in place, add the longer channels.
3. Line the LED light to the top of the frame and then push till you hear a click. The click will indicate that the light is secured.
4. Once the light is secure, plug the smaller end of the power cord into the light.
5. Plug the power cord and transformer together.
6. Attach the print by sliding the silicone edging (sewn into the print), into the channel bars on the frame. We recommend starting in one corner and working your way around the frame. Do the same thing for the diffuser.
7. Line up the notch in the countertop to the top of the frame and gently set it in place.
8. Plug in the SEG promo counter and then it is ready to use!