

# Event Barrier Basic

R4.091115

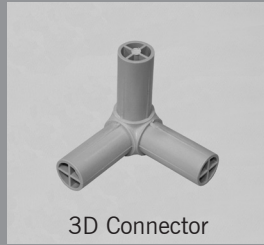

**RECOMMENDED:** Lay out all poles and accessories into the desired style to allow for easy assembly.

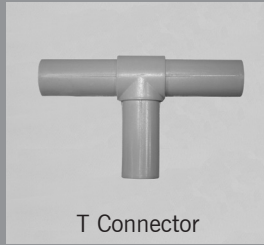
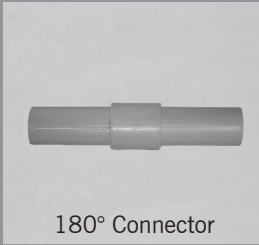
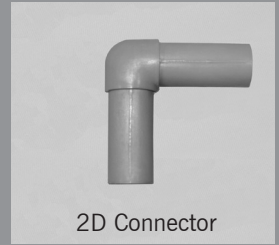
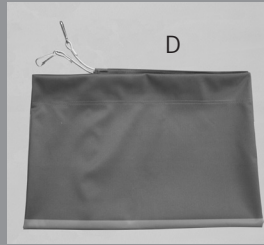
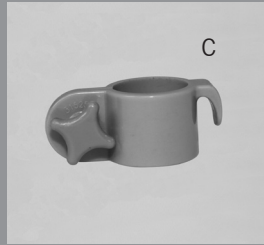
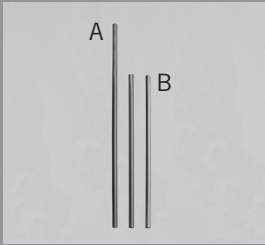
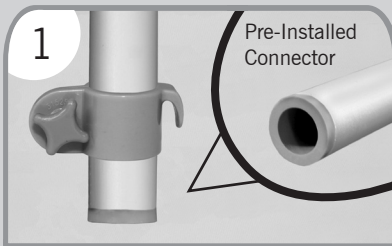

1. Locate the short poles (B) with the Connectors at the bottom. Add the Clamps (C) to the bottom of the poles.

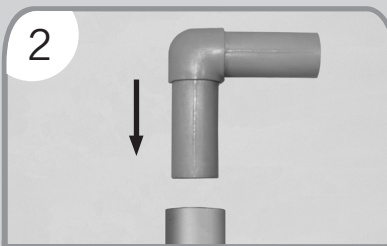

2. Attach the appropriate connector(s) to the short poles (B).



3. Begin sliding the long poles (A) through the pole sleeve on the print(s) (D).

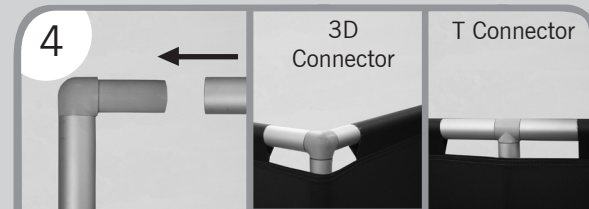

4. Mount the long poles (A) in place. If using a continuous print, you will need to insert additional 180° poles and appropriate connectors during assembly.



5. Attach the bungee cord(s) to the hook of the Clamp (C). If using multiple panels, two bungee cords will share a Clamp (C) for every connected panel.



Do not set up your Barrier System in wind gusts (24-31 mph or higher) and/or severe storms. User must read and observe assembly sheet. If this is done incorrectly it may result in damage to the unit, injury or death, and all warranties will be void. All warranties will be void if this product is used with any print or hardware not produced by us.

