

ASSEMBLY HARDWARE

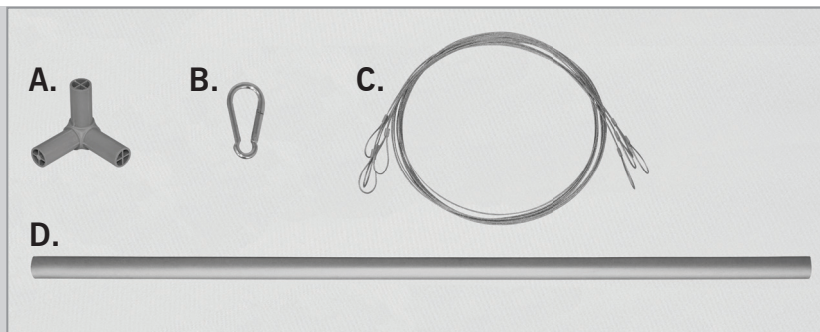

A. 3D Connector(s)
C. Steel Rope

B. Carabiner Snap Hook
D. Aluminum Pole(s)

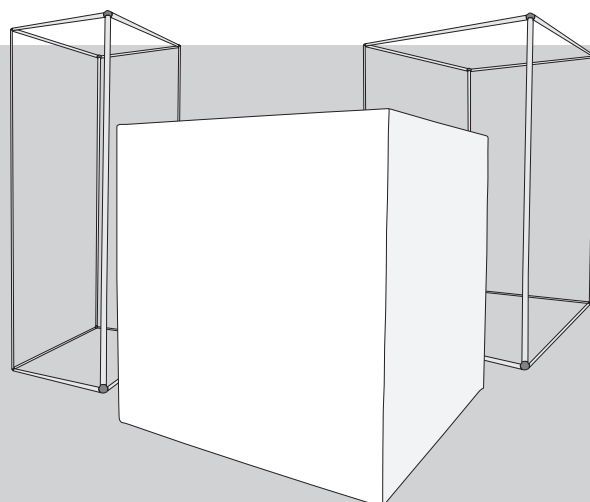

ASSEMBLY

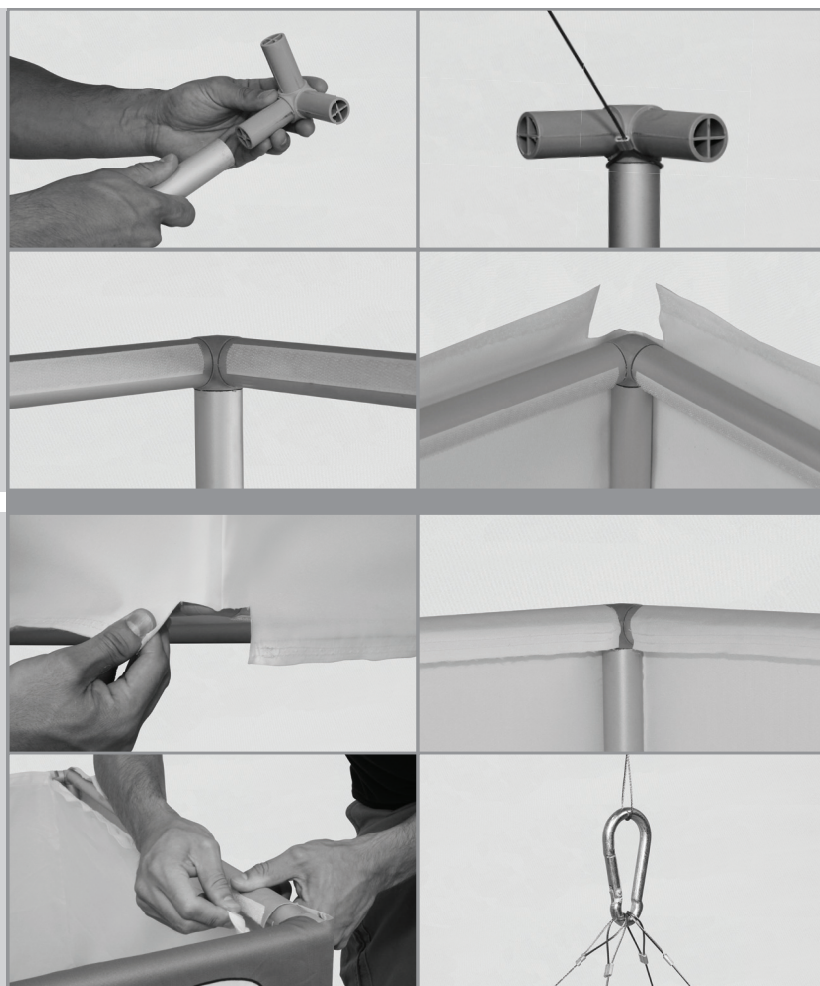

1. Assemble the Aluminum poles (D) and 3D connectors (A) to create the Cube, Cuboid Square Base, or Cuboid Rectangular Base display.

- If the model is being hung, slip the bottom of all top connectors through one of the looped ends of the Steel Rope (C). Attach 3D Connectors (A) and Steel Rope (C) to Aluminum poles (D).
- If the print is a closed top or single-reverse, then assemble Aluminum poles (D) with the hook-and-loop adhesive so they will line up with the print. The hook-and-loop adhesive on the Aluminum poles (D) should also be angled inward slightly to make the print taut.

2. Attach print depending on layout option:

- **Closed Top** – Slip print over the top of the frame and pull taut. Wrap the tabs on the bottom of the print under the bottom of the frame and attach to the hook-and-loop adhesive.
- **Single-reverse** – Slip print over the top of the frame. Wrap the tabs on the top of the print over the top of the frame and attach to the hook-and-loop adhesive. Pull print taut and wrap the bottom print tabs under the frame and attach to the hook-and-loop adhesive.
- **Double-sided** – Flip frame upside down and slip the print on upside down. Flip frame and print over and pull the print upwards. Wrap the outside of the print over the frame and attach to the inside of the print using the hook-and-loop adhesive.

3. If being hung, feed the 4 non-attached loops of Steel Rope (C) through the Carabiner Snap Hook (B) and attach to a suitable mounting location.